

The Boom will close on the Tavern. The Dining Room and Dance area is preset during the Tavern scene. I have a dressing screen and mirror. Perhaps just the mirror. The Beast starts the scene getting dressed in front of the Boom. Then it opens to the dining room. Belle makes a grand entrance down the stairs.

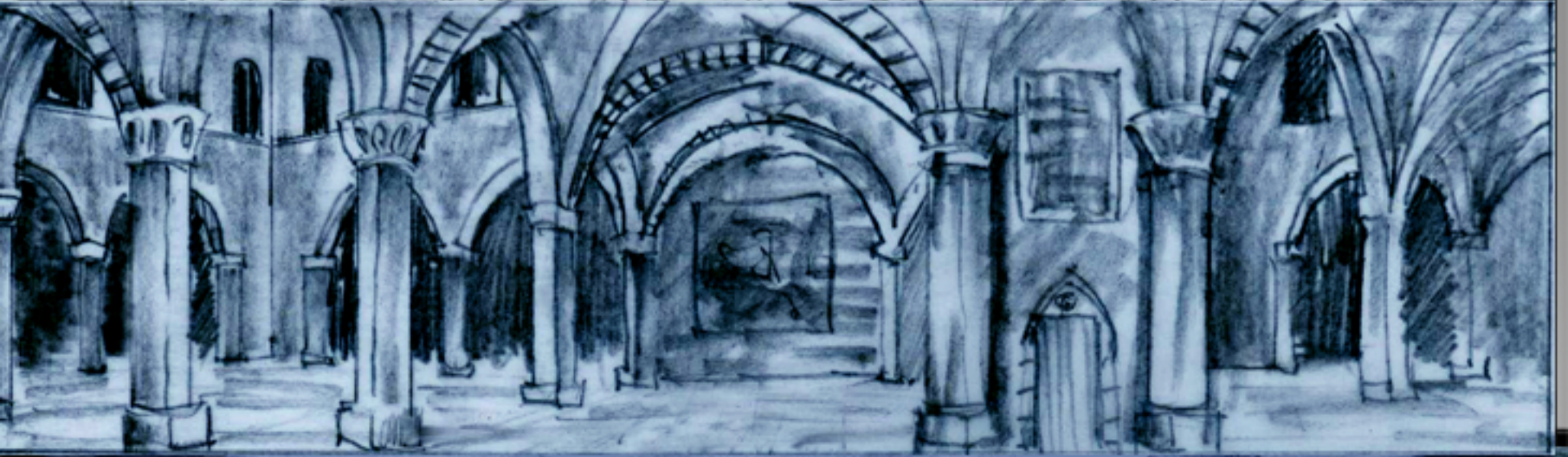

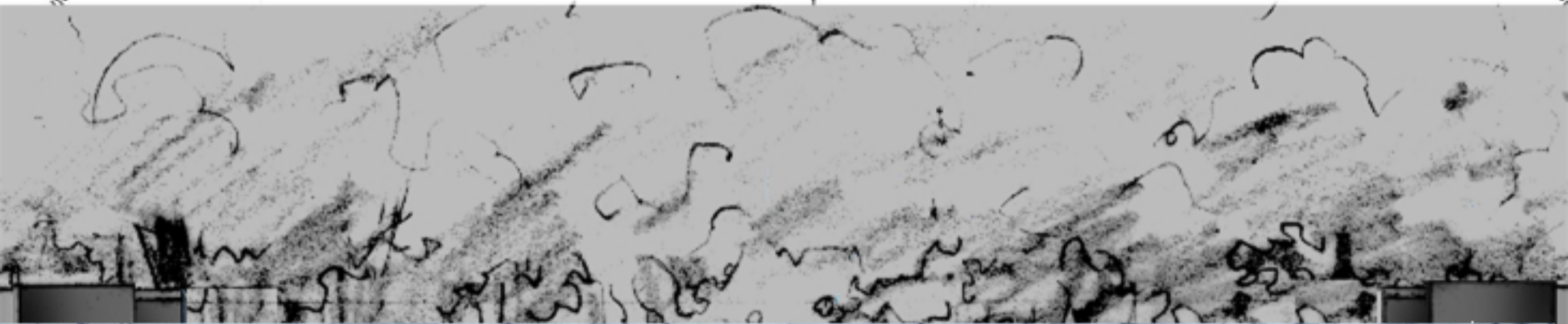

The mob goes to Belle's Cottage. Gaston uses the stump to rally the mob. As they go to the castle, the Forest flipper closes over the house in the boom like in Act One. During this scene/s, the West Wing battle scene is set up.

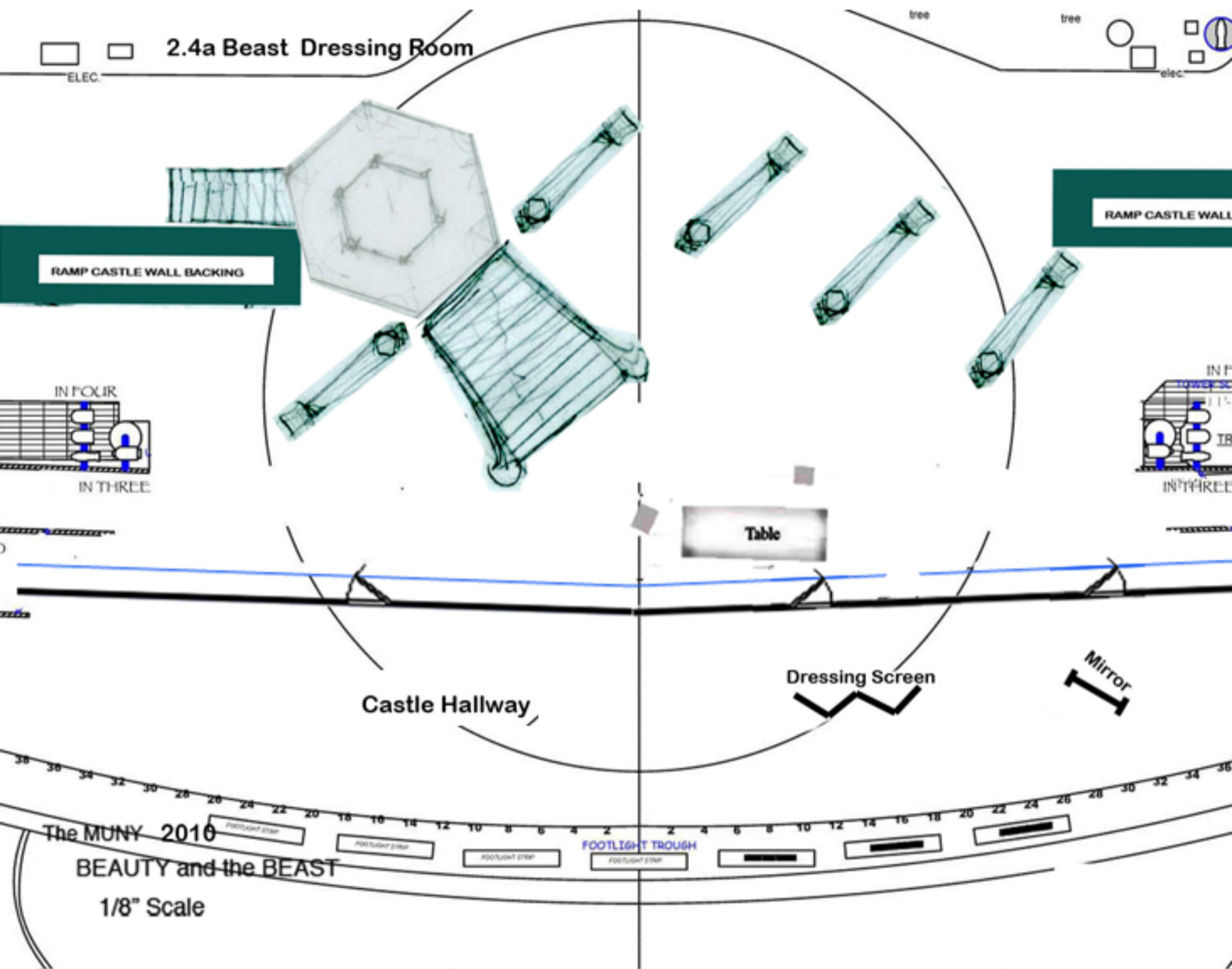
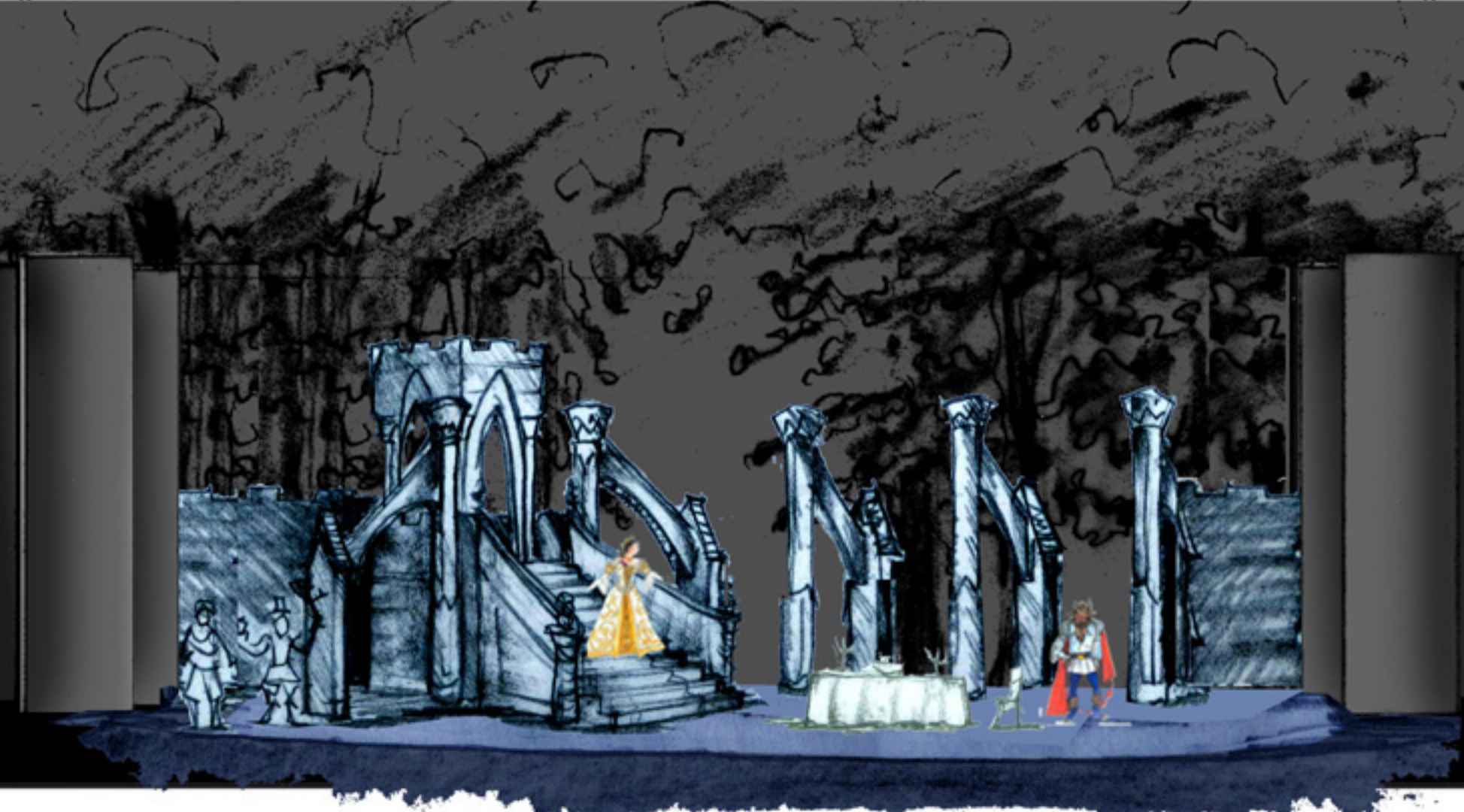
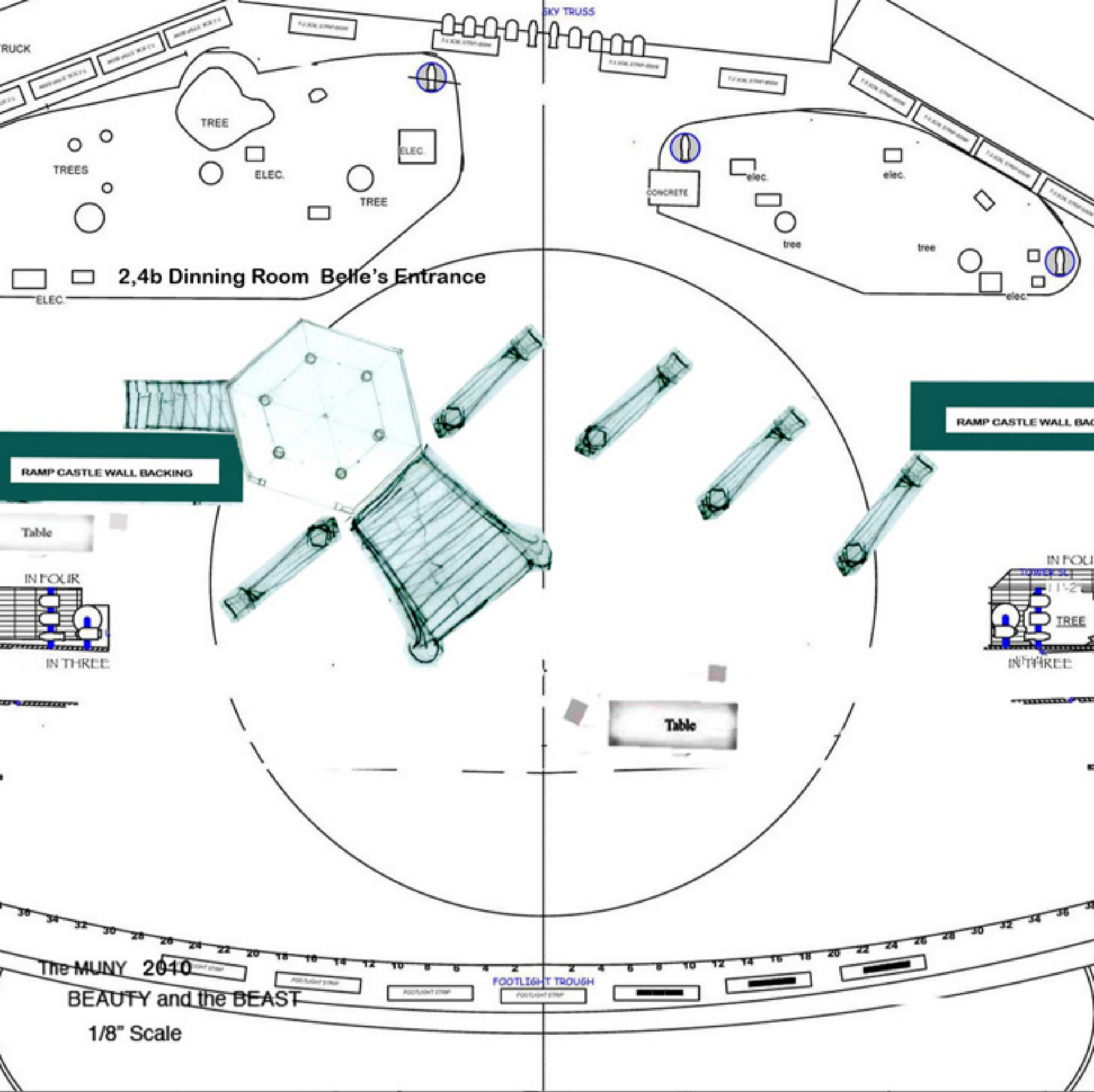